

**KEITH TIMBER**  
Frames Trusses

**Phone: (08) 8755 1233**  
13 Park Terrace Keith S.A. 5267

Winner of Multiple FTMA Awards  
Since 2007

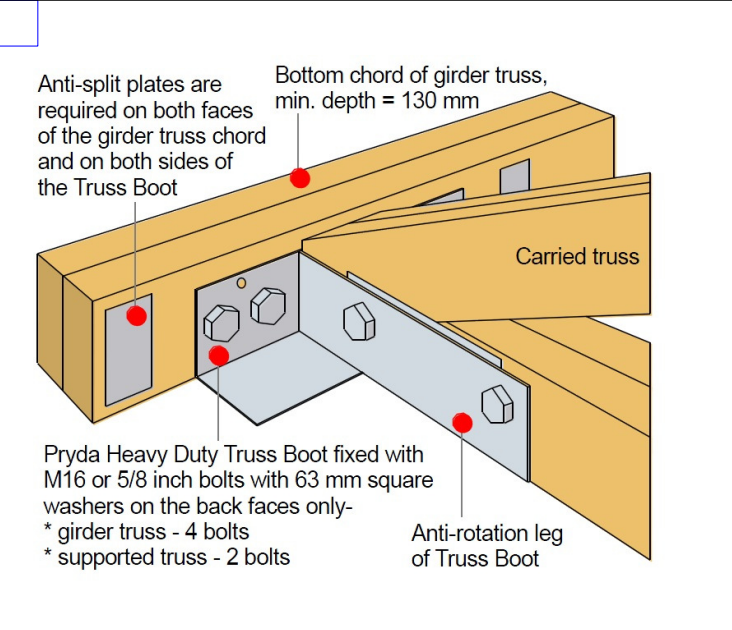

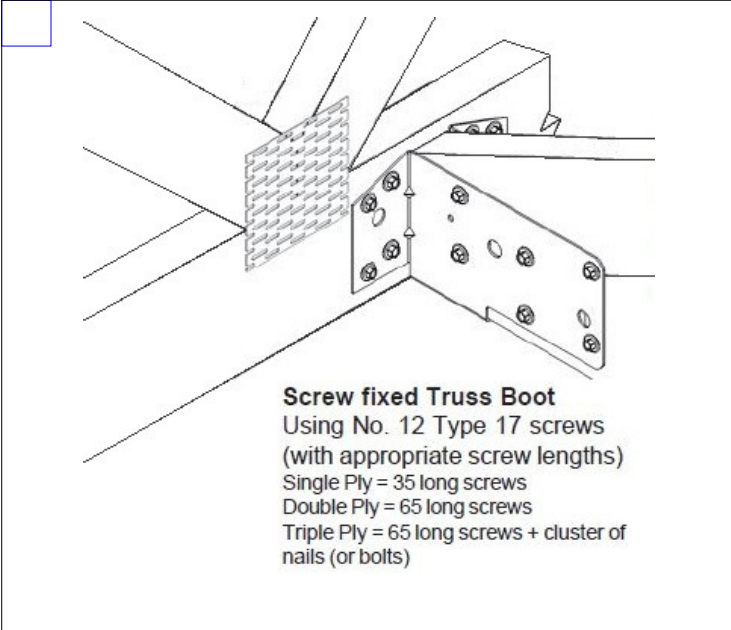
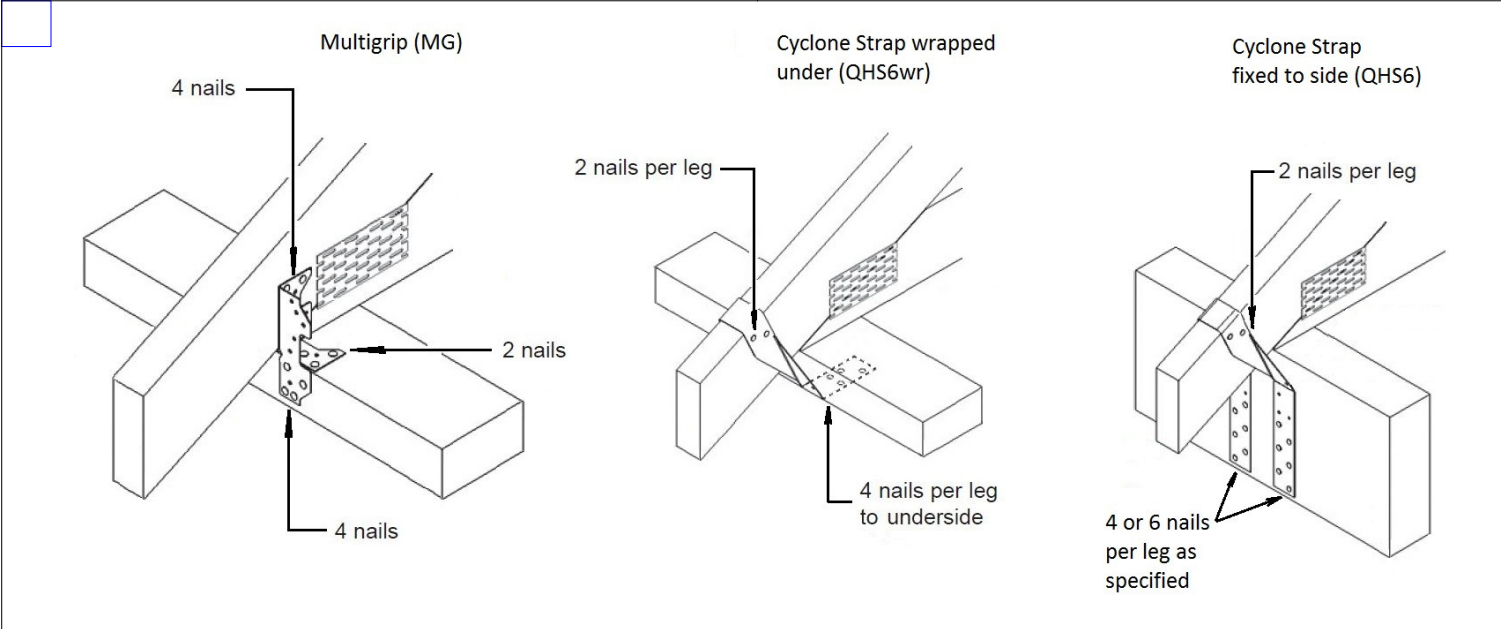
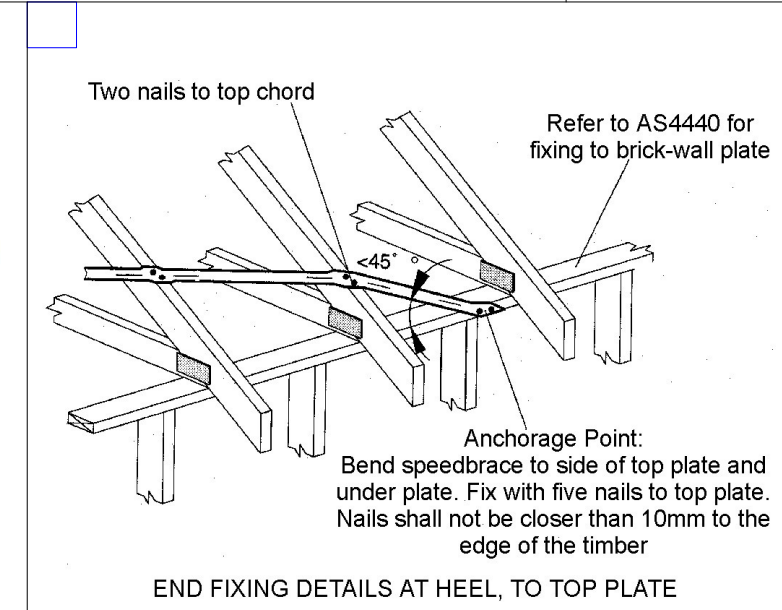
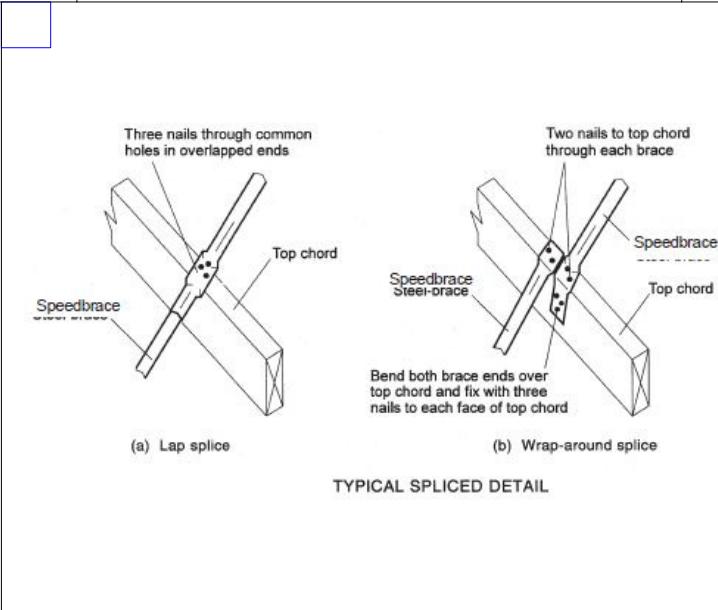
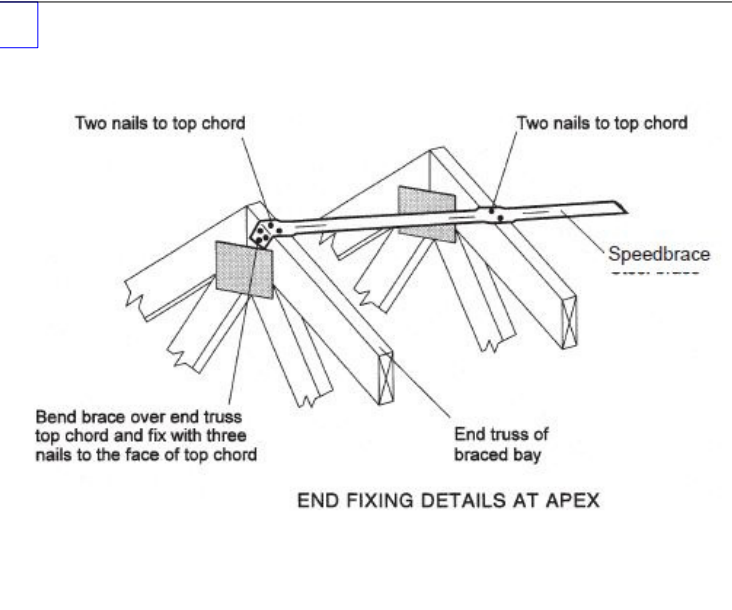

**Fixing Details For Double & Triple Girders- Screws Only Fixing Option**

**DOUBLE GIRDERS**  
**2@ 35 Girder Laminations – Preferred Fixing Detail**

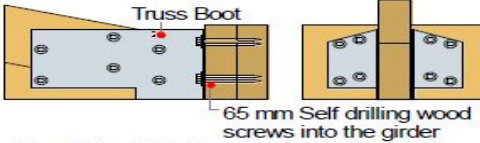

65 mm Self drilling wood screws into the girder

**Alternative Fixing Detail**

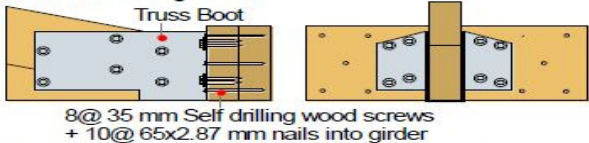

8@ 35 mm Self drilling wood screws + 10@ 65x2.87 mm nails into girder

**2@ 45 Girder Laminations – Preferred Fixing Detail**

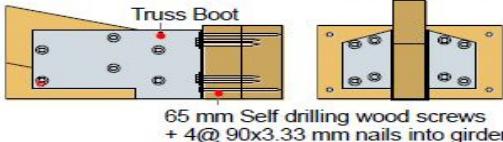

65 mm Self drilling wood screws + 4@ 90x3.33 mm nails into girder

**Alternative Fixing Detail**



35 mm Self drilling wood screws + 8@ 90x3.33 mm nails into girder

**TRIPLE GIRDERS**  
**3@ 35 or 3@ 45 mm Laminations – Preferred Fixing**

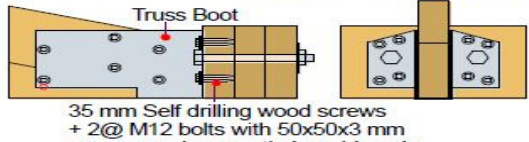

35 mm Self drilling wood screws + 2@ M12 bolts with 50x50x3 mm square washers on timber side only

**Alternative Fixing Detail**



35 mm Self drilling wood screws + 18@ 90x3.33 mm nails: (12 to front lamination, 6 to back lamination)

**Notes**

- Nails at the Truss Boot are to be spaced 70mm (min) apart along the grain and 40 mm (min) apart across the grain. They should be as close to the Truss Boot as practical, but not further away than the depth of the member.
- Use the details for 35 mm laminates for timber thickness between 35 and 40 mm, and the 45 mm details for timber thickness between 41 and 50 mm.
- All screws are to be **No. 12 x35 mm Type 17 hex. head** or No 12 x65 mm Type 17 hex head.
- For all double and triple girder trusses, the chords (top and bottom) and webs are to be nailed at:

Timber Width	Nail Rows & Maximum Spacing
Up to 100 mm	2 rows at 500 mm
101 - 200 mm	2 rows (staggered) at 250 mm
201 - 300 mm	3 rows (staggered) at 250 mm

